

AIR FORCE
ARMY
MARINE CORPS

T.O. 35E9-188-4
TM 11-5895-1045-24P
TM SL-4-08045-15/7

**TECHNICAL MANUAL
ILLUSTRATED PARTS BREAKDOWN**

**AIR CONDITIONER GROUP
OA-8840(V)2/T
PART NUMBER 2037603-1**

**TEXAS INSTRUMENTS INCORPORATED
F1962877-C-0126**

**Each transmittal of this document outside of the Department of Defense must have approval of the
issuing Service**

Published under authority of the Secretary of the Air Force.

AIR FORCE (2) APRIL 6, 1981-450-ORIGINAL

1 MAY 1980

TABLE OF CONTENTS

<i>Section</i>	<i>Title</i>	<i>Page</i>
I	INTRODUCTION TO THE ILLUSTRATED PARTS BREAKDOWN	1-1
II	PARTS LIST	2-1
	Air Conditioner Group, OA-8840(V)2/T	2-2
	Turning Vane Assembly	2-9
	Shelter Repair Kit Assembly	2-11
	Power Distribution Cabinet Assembly	2-13
	Air Conditioner Control Relay Assembly	2-19
	Plenum Assembly	2-21
	Environmental Control Unit	2-24
III	NUMERICAL INDEX	3-1
IV	REFERENCE DESIGNATION INDEX	4-1

i/(ii blank)

SECTION I

INTRODUCTION TO THE ILLUSTRATED PARTS BREAKDOWN

1-1. SCOPE.

1-2. This Illustrated Parts Breakdown lists and illustrates the Air Conditioner Group OA-8840(V)2/T, part number 2037603-1.

1-3. RELATED PUBLICATIONS.

1-4. The following related publication contains maintenance and overhaul instructions for the equipment covered by this Illustrated Parts Breakdown.

T.O. 35E9-170-1	Operating & Maintenance Instruction Manual
T.O. 35E9-170-3	Overhaul Manual

1-5. SECTION I-INTRODUCTION TO THE ILLUSTRATED PARTS BREAKDOWN.

1-6. Section I defines and explains the use of the Illustrated Parts Breakdown.

1-7. SECTION II-MAINTENANCE PART LIST.

1-8. The Maintenance Parts List (MPL) consists of the Air Conditioner Group OA-8840(V)2/T broken down into assemblies, subassemblies, and detail parts. The following paragraphs define the use of each column.

1-9. FIGURE AND INDEX NUMBER. The column contains the numerically assigned figure numbers for each illustration. Within each figure, numerically arranged index numbers are assigned to aid in locating a part in the Maintenance Parts List and the associated illustrations. If more than one sheet is required to illustrate the assembly, the sheet number will follow the figure number separated by a diagonal (/).

1-10. PART NUMBER. The numbers listed in this column are those pertaining to the manufacturer, except in the case of Government standard parts (AF, AN, MS, JAN, MIL, and USN), and are used exclusively to identify parts. Parts which are used exactly as purchased, i.e., in a condition ready for installation, are listed in the Part No. column by the manufacturer's part number with the Texas Instruments specification control number parenthetically following the description in the description column. An asterisk (*) following a part number signifies that the part must be requisitioned in accordance with the requirements of AFR 6-4. A number sign (#) following a part number identifies the item as GFE/CFE and signifies that a detailed parts breakdown appears in a separate manual. Reference should be made to paragraph 1-4 for related publications. In general, assemblies and parts installed at the time the end item was manufactured are listed and identified in the manual. When an assembly or part (including vendor items), different from the original, was installed during the manufacture of later items, series, or blocks, all assemblies or parts are listed and identified by a "Usable-on" code (see 1-15). However, when the original assembly or part does not have continued application (no spares of the original were procured or such spares are no longer authorized for replacement), only the preferred assembly or part is listed. Also,

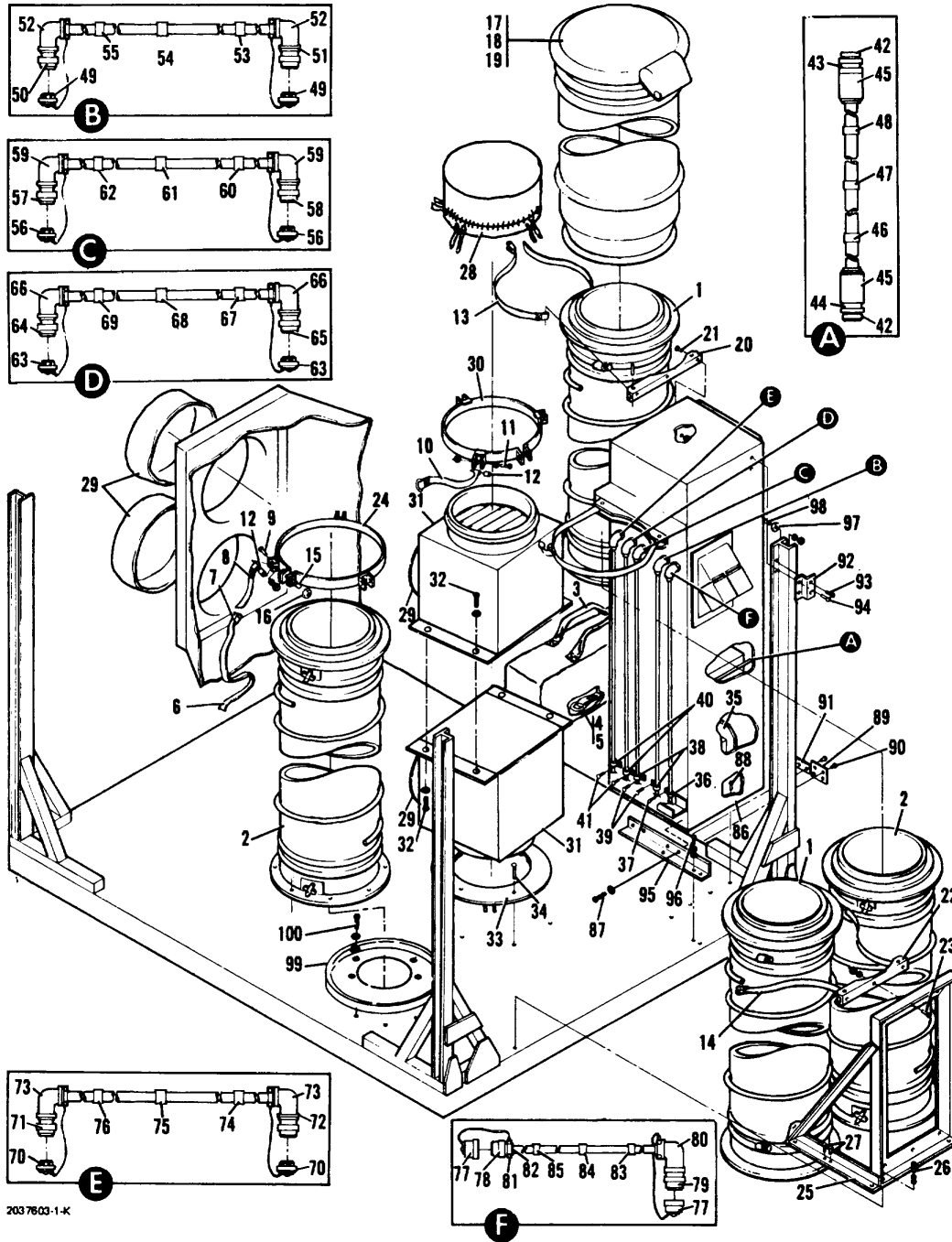

Figure 1. Air Conditioner Group, OA-8840(VJ2/T (Sheet 1 of 2)