

TECHNICAL MANUAL
FOR SCRAPER, EARTH MOVING, MOTORIZED
DIESEL ENGINE DRIVEN
NSN 3805-01-153-1854

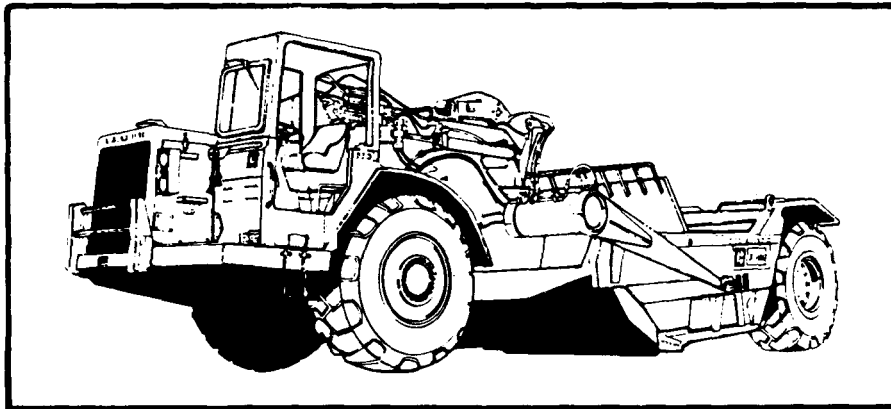

REPAIR PARTS

HEADQUARTERS, DEPARTMENT OF THE ARMY
AUGUST 1985

TECHNICAL MANUAL
NO. 5-3805-248-14&P-4

HEADQUARTERS
DEPARTMENT OF THE ARMY
Washington, DC 19 Aug 1985

TECHNICAL MANUAL
FOR
SCRAPER, EARTH MOVING, MOTORIZED
DIESEL ENGINE DRIVEN
NSN 3805-01-153-1854
REPAIR PARTS

REPORTING OF ERRORS

You can help improve this manual. If you find any mistakes or if you know of a way to improve the procedures, please let us know. Mail your letter, DA Form 2028 (Recommended Changes to Publications and Blank Forms) or DA Form 20282 located in the back of this manual direct to: Commander, US Army Tank-Automotive Command, ATTN: AMSTAMPB, Warren, MI 483975000. A reply will be furnished direct to you.

TABLE OF CONTENTS
General Description and Specifications

	PAGE
Schematic.....	2
Basic Engine.....	5
Lubrication System.....	29
Cooling System.....	35
Intake and Exhaust System.....	45
Fuel System and Governor.....	59
Starting and Electrical System.....	77
Power Train - Power Transmission Unit.....	105
Steering and Braking System.....	141
Chassis.....	175
Hydraulic System.....	187
Cab, Gauges and Accessories.....	203
Scraper.....	230
Service Equipment and Supplies.....	258

This technical manual is an authentication of the manufacturers commercial literature and does not conform with the format and content specified in AR 310-3, Military Publications. This technical manual does, however, contain available information that is essential to the operation and maintenance of the equipment.

MACHINE IDENTIFICATION

Caterpillar machines are identified with SERIAL NUMBERS. Serial numbers are assigned to the chassis and to the engine. The chassis and the engine also carry ARRANGEMENT NUMBERS and in some cases MODIFICATION NUMBERS. These numbers are shown on the serial number plates and on the master plate in the operator's compartment. For the location of the serial number plates, refer to the Specification Section at the back of this Parts Book. Caterpillar dealers need these numbers to determine which components were included on the machine when it was assembled at the factory. This permits accurate identification of replacement part numbers.

ORDERING PARTS

Quality Caterpillar Replacement parts are available from Caterpillar dealers throughout the world. Their parts stocks are up to date and include all parts normally required to protect your investment in Caterpillar machines. When ordering parts, your order should specify the quantity, part number, part name and the serial number, arrangement number and any modification numbers of the machine for which the parts are needed. If in doubt about the part number, please provide your dealer with a complete description of the needed item.

HOW TO USE THE PARTS BOOK

Caterpillar Parts Books include illustrations of the groups or assemblies which make up the machine. These illustrations show the standard components plus many of the attachments available for the machine.

The alphabetical index located in the front part of the book should be used to determine the page number on which specific illustrations are shown. Reference to those pages will identify each of the individual serviceable parts.

Captions

The caption under each illustration identifies the part number and name of the group or assembly shown. If more than one illustration is included for any group, the caption identifies the specific machine serial numbers to which each illustration applies. In some cases it is not possible to determine the specific machine serial numbers to which different illustrations are applicable. In those cases the caption identifies the illustration as "First Type", "Second Type", etc. Reference to the actual group or assembly is necessary in those cases to determine which illustration should be used.

Captions provide additional information such as page numbers where illustrations of sub assemblies are shown, information regarding quantities used and other information intended to assist the user in determining parts needs.

Indented Part Names

Within each illustration is a parts list identifying each serviceable part in the illustration. When a part name is indented in this list, it means that serviceable item is a part of the serviceable item under which it is indented.

Abbreviations and Symbols

- A Used to call attention to additional information shown elsewhere within the illustration.
 -
 - R.H. Right Hand Refers to the side of the machine as viewed from the operator's compartment.
 - L.H. Left Hand
 - C Indicates changes from the previous illustration of the same group or assembly.
 - O.D. Outside Diameter
 - I.D. Inside Diameter
 - N/S Not Serviced
 - Assem. Assembly
 - in. Inch
 - ft Foot
 - cm Centimeter
 - dm Decimeter
- Note: Continuing improvement and advancement of product design may cause changes to your machine which may not be included in this publication. Each publication is reviewed and revised, as required, to update and include these changes in later editions.

Whenever a question arises regarding your Caterpillar product, or this publication, please consult your Caterpillar dealer for the latest available information.

TABLE OF CONTENTS

ENGINE ARRANGEMENTS ARE LISTED STARTING ON PAGE 3

Name	Page
A	
Aftercooler	52
Aftercooler Water Lines	53
Air Cleaner	44
Air Compressor	47
Air Compressor Lines	46
Air Dryer	151
Air Lines - Turbocharger Inlet and Outlet	45
Air Tank	141
Alternator	88
Apron	235
Apron Cylinder	236
Apron Lift	237
Auxiliary Drive Pulley	25
B	
Back-Up Warning	87
Bowl	238
Bowl Cylinder	240
Brake	249
Brake Actuator	146,248
Brake Control	142,245
C	
Cab Window	209
Cab Windshield	210
Camshaft	11
Camshaft Assembly	12
Cartridge	169,201
Case Assembly	222

Name	Page
Connecting Rod and Piston	to
Control - Trailing Unit	187
Control Console	228
Crankcase Guard	186
Crankshaft	8
Crankshaft Assembly	9
Cylinder Block	16
Cylinder Block Covers	5
Cylinder Head	13
D	
Differential	133
Differential and Bevel Gear	134
Differential Lock Control	140
Draft Frame	230
Draft Frame Lines	231
Drive Shaft	136
Dust Ejector	58
E	
Edge and Bit	237
Ejector	242
Ejector Cylinder	244
Ejector Lines	241
Engine Arrangements	3
Engine Compartment Shield	57
Engine Support	19
Ether Starting Aid	93
Exhaust Extension	55
Exhaust Manifold	55

TABLE OF CONTENTS - CONTINUED

F

Name	Page
Fan - Defrosting.....	215
Fan - Suction.....	41
Fan Belt Drive.....	23
Fan Belt Tightener.....	24
Fender.....	182,185
Filter - Aftercooler Coolant.....	54
Filter - By-Pass.....	197
Filter - Fuel.....	71
Filter - Internal.....	197
Filter - Primary Fuel.....	70
Filter - Transmission.....	127
Final Drive and Wheel.....	138
Flywheel.....	25
Flywheel Housing.....	26
Flywheel Housing Cover.....	27
Frame and Case.....	174
Front Accessory Drive.....	24
Front Bumper.....	177
Front Housing - Engine.....	20
Front Housing Cover - Engine.....	20
Front Housing Fastener.....	21
Front Timing Gear - Engine.....	21
Fuel Filter Lines.....	68
Fuel Injection Lines.....	67
Fuel Injection Pump.....	63
Fuel Lines.....	69
Fuel Priming Pump.....	70
Fuel Ratio Control.....	72
Fuel Tank.....	74
Fuel Transfer Pump.....	66

Fumes Disposal.....	33
G	
Name	Page
Gauge - Oil Level.....	217
Governor.....	61,125
Governor Control.....	59
Governor and Drive - Transmission.....	124
Governor and Fuel Injection Pump.....	60
Governor and Fuel Pump Drive.....	65
H	
Harness - Battery and Wiring.....	81
Harness - Cab Pressurizer.....	220
Heater.....	218,227
Heater Lines.....	224
Heater and Mounting.....	226
Heater Wiring.....	225
Hitch.....	183
Hood.....	181
Horn - Air.....	214
Hydraulic Tank and Filter.....	198
L	
Lamp - Flood.....	84
Lamp - Head.....	84
Lifting Eye.....	18
Lighting and Wiring.....	76
Lighting - Blackout.....	85,254
Literature.....	253

TABLE OF CONTENTS - CONTINUED

M

Name	Page
Manifold and Screen - Transmission	123
Muffler	56

O

Oil Cooler - Brake	42
Oil Cooler - Engine	42
Oil Cooler - Torque Converter	43
Oil Filler - Engine	29
Oil Level Gauge	28
Oil Level Guide	28
Oil Lines - Engine	31
Oil Lines - Power Train	128
Oil Lines - Remote Mount Filter	32
Oil Pan	27
Oil Pump	30
Oil Pump Mounting Fastener	29
Oil Sampling	30
Operator Compartment	178

P

Paint and Lubricant	252
Planetary Transmission	104
Power Train Schematic	2
Pressurizer	219
Protection Cover - Radiator Cap	37
Pump	166
Pump - Double Vane	167
Pump - Gear	132,166
Pump - Scavenge - Transmission	126

Name	Page
Pump - Transmission	126
Pump - Vane	168

R

Radiator	34
Radiator Guard	185
Radio Interference Suppression	87
Rear View Mirror	213
Retarder	132
Retarder Control	130
Return Air Console	223
Rocker Arm - Valve Mechanism	16
ROPS - Enclosed	206
Rubber Damper	22

S

Safety Tread	229
Seat	204
Seat Suspension	202
Service Brake	150
Servo-Receiver Steering Cylinder	170
Shaft and Pivot Assembly	212
Slack Adjuster	149,250
Solenoid Assembly	101
Starting Motor - Electric	94
Steering Cylinder	172
Steering Gear	164
Steering Lines	155
Steering Lines - Cylinder	160

TABLE OF CONTENTS - CONTINUED

Name	Page
Steering Servo-Receiver Mounting.....	
and Cylinder	171
Switch - Disconnect.....	83
Switch - Solenoid Assembly	101
.....	
Tachometer Drive	75
Tire	140,252
Tire Inflation.....	154
Torque Control	64
Torque Converter	122
Transfer Gear	120
Transmission Arrangement	102
Transmission Case and Covers	103
Transmission Control	117
Transmission Hydraulic Control	108
Trunnion - Engine	22
Turbocharger.....	48
Turbocharger Cartridge	50
Turbocharger Oil Lines.....	51
Turn Stop.....	186
Water Lines - Engine Oil Cooler.....	39
Water Lines - Retarder Oil Cooler	40
V	
Valve - Air Control	196
Valve Assembly.....	116,146

Name	Page
Valve - Automatic Pressure Control and Selector	111
Valve - Automatic Selector.....	115
Valve - Automatic Shifting - Hydraulic Control.....	110
Valve - Breaker Relief	200
Valve - Check.....	234
Valve - Control	147,193
Valve - Control Assembly.....	147,195
Valve - Double Check	148
Valve - Governor Cut-Off - Automatic Shifting	116
Valve - Pressure Reducing	161
Valve - Relief.....	171
Valve - Retarder Assembly	131
Valve - Shift Pressure	114
Valve - Steering.....	162
Valve Mechanism - Engine	15
Valve Mechanism Cover	17

W

Water Pump	37
Wheel - Rear	251
Windshield Wiper	211
Wiring	256

WARRANTY STATEMENT

The Caterpillar 621B Tractor-Scraper is warranted by Caterpillar Tractor Co. for 15 months or 1500 hours of operation, whichever occurs first. The warranty starts on the date found on the DA form 24089 in the log book. Report all defects in material or workmanship to your supervisor, who will take appropriate action through your organizational maintenance shop.

**QUICK
REFERENCE GUIDE
TO MAJOR SECTIONS**

SCHEMATIC	▶
BASIC ENGINE	▶
LUBRICATION SYSTEM	▶
COOLING SYSTEM	▶
INTAKE AND EXHAUST SYSTEM	▶
FUEL SYSTEM AND GOVERNOR	▶
STARTING AND ELECTRICAL SYSTEM	▶
POWER TRAIN - POWER TRANSMISSION UNIT	▶
STEERING AND BRAKING SYSTEM	▶
CHASSIS	▶
HYDRAULIC SYSTEM	▶
CAB, GAUGES AND ACCESSORIES	▶
SCRAPER	▶
SERVICE EQUIPMENT AND SUPPLIES	▶

CATERPILLAR 621B TRACTOR

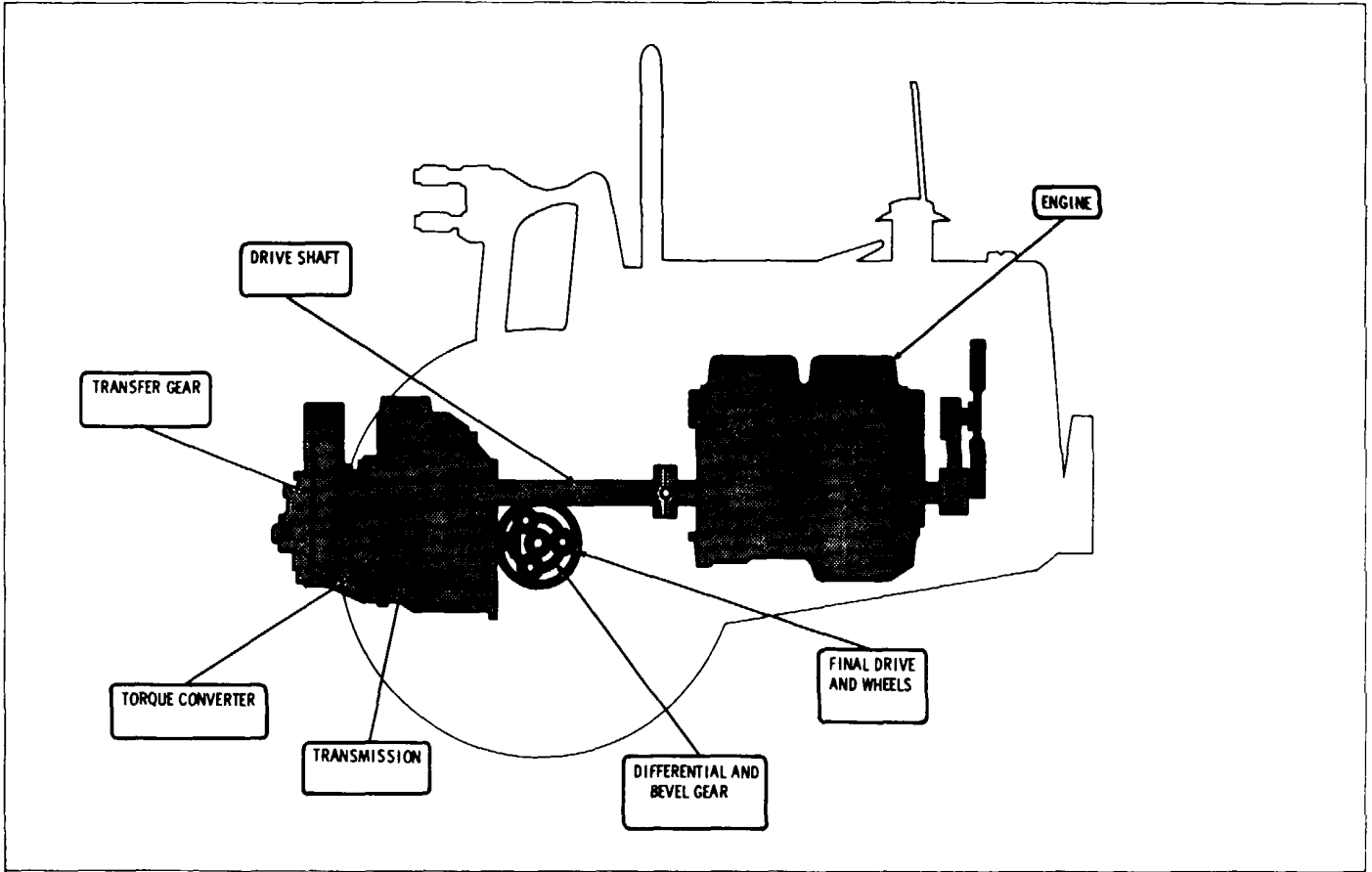

POWER TRAIN ARRANGEMENT

POWER TRAIN ARRANGEMENT

CATERPILLAR 621B TRACTOR

CONSISTS OF:

PAGE

CENTRAL STRUCTURE

1	6N4992	CAMSHAFT GROUP	11
6	7N3516	CONNECTING ROD AND PISTON GROUP	10
1	2W1732	CRANKSHAFT GROUP	8
1	9N684	CYLINDER BLOCK COVER GROUP	5
1	4N2257	CYLINDER BLOCK GROUP	6

UPPER STRUCTURE

1	4N2270	CYLINDER HEAD GROUP	13
1	4N744	LIFTING EYE GROUP.....	18
1	4N4953	VALVE MECHANISM COVER GROUP	17
1	4N2271	VALVE MECHANISM GROUP	15

FRONT STRUCTURE

1	4N2264	FRONT ACCESSORY DRIVE GROUP.....	24
1	4N2274	FRONT TIMING GEAR GROUP	21
1	4N4965	FRONT HOUSING COVER GROUP	20
1	4N6006	FRONT HOUSING FASTENER GROUP	21
1	4N3911	FRONT HOUSING GROUP	20
1	4N1,560	RUBBER DAMPER GROUP	22
1	4N2276	SUPPORT GROUP	19
1	4N2273	TRUNNION GROUP.....	22

REAR STRUCTURE

1	7N9651	FLYWHEEL GROUP	25
1	4N4792	FLYWHEEL HOUSING COVER GROUP	27
1	BN5941	FLYWHEEL HOUSING GROUP	26

LOWER STRUCTURE

1	4N771	OIL PAN GROUP	27
---	-------	---------------------	----

5R6706 ENGINE ARRANGEMENT-Part 1 of 2

NOTE: WHEN ORDERING PARTS GIVE ENGINE ARRANGEMENT

CATERPILLAR 621B TRACTOR

CONSISTS OF:			PAGE
<u>LUBRICATION SYSTEM</u>			
1	2N8220	BREATHER GROUP	33
1	4N2738	FUMES DISPOSAL GROUP	33
1	4N8121	OIL FILLER GROUP	29
1	4N8812	OIL LEVEL GAUGE GROUP	28
1	4N8733	OIL LINES GROUP	31
1	4N733	OIL PUMP GROUP	30
1	4N2481	OIL PUMP MOUNTING FASTENER GROUP	29
<u>COOLING SYSTEM</u>			
1	4N729	OIL COOLER GROUP	42
1	4N1641	WATER LINES GROUP	39
1	9N3288	WATER PUMP GROUP	37
<u>INTAKE AND EXHAUST SYSTEM</u>			
1	4N9010	AFTERCOOLER GROUP	52
1	4N2474	AFTERCOOLER WATER LINES GROUP	53
1	7N6294	AIR COMPRESSOR GROUP	48
1	8N6024	AIR COMPRESSOR LINES GROUP	46
1	BN5416	AIR LINES GROUP	45
1	9N22	EXHAUST MANIFOLD GROUP	55
1	8N5444	TURBOCHARGER GROUP	48
1	9N13	TURBOCHARGER OIL LINES GROUP	51
<u>FUEL SYSTEM AND GOVERNOR</u>			
1	9N3672	FUEL INJECTION LINES GROUP	67
1	4N1981	FUEL FILTER GROUP	71
1	4N2292	FUEL FILTER LINES GROUP	68
1	9N792	FUEL RATIO CONTROL GROUP	73
1	4N3949	FUEL TRANSFER PUMP GROUP	66
1	6N5202	GOVERNOR AND FUEL PUMP DRIVE GROUP	65
1	8N5535	GOVERNOR AND FUEL PUMP GROUP	60
1	4N3064	TACHOMETER DRIVE GROUP	75
NOTE: REFER TO INDEX FOR PAGE LOCATION OF GASKET KITS			
5R6706 ENGINE ARRANGEMENT-Part 2 of 2			
NOTE: WHEN ORDERING PARTS GIVE ENGINE ARRANGEMENT			

BASIC ENGINE

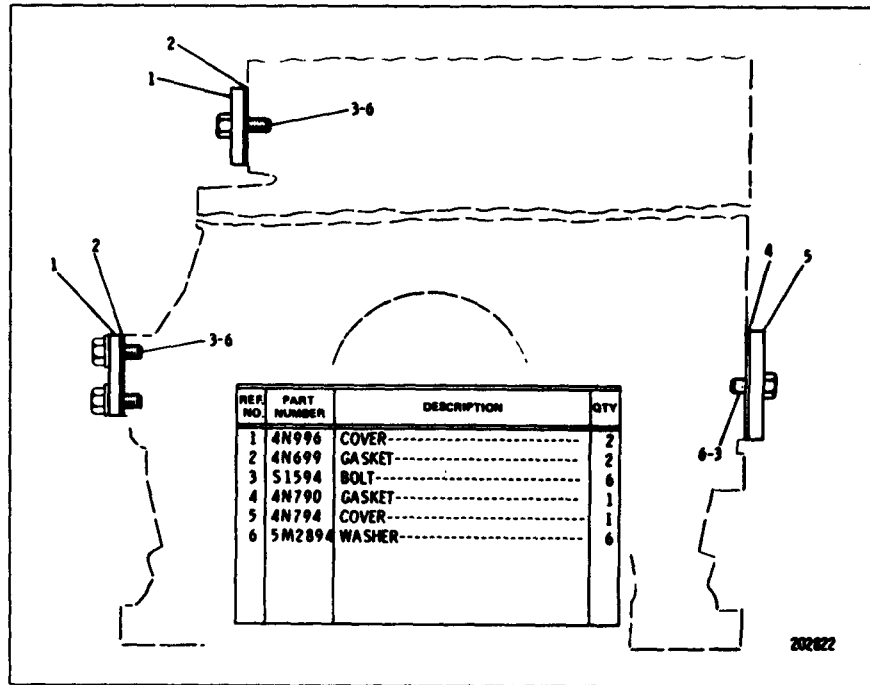

9N664 CYLINDER BLOCK COVER GROUP

CATERPILLAR 621B TRACTOR

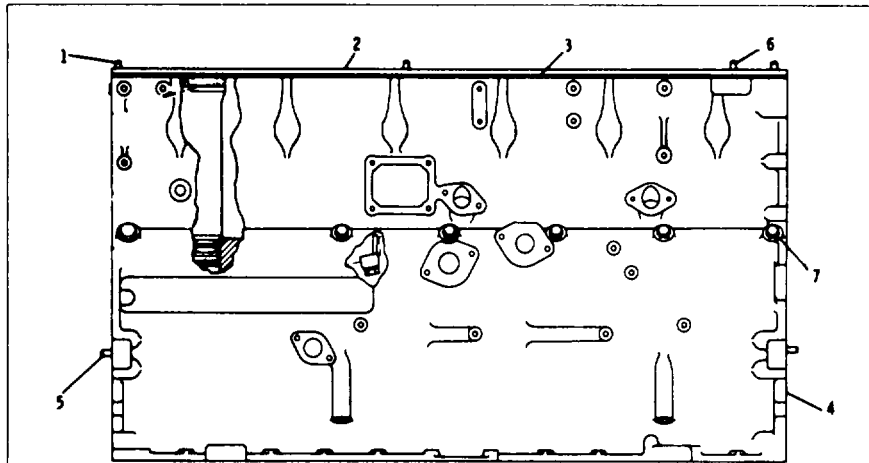

REF. NO.	PART NUMBER	DESCRIPTION	QTY
1	4N1650	DOWEL-----	2
2	7N1199	PLATE-----	1
3	7N625	GASKET-----	1
4	8N9266	CYLINDER BLOCK ASSEM.---	1
		CONSISTS OF:	
	9L5854	BAND-----	6
	1W6280	LINER-----	6
	8N9265	BLOCK-----	1
	6V5321	SEAL-----	18
	3P1323	BOLT-----	14
	9W1031	WASHER-----	14
	4N795	CAP-----	7

5	4N683	DOWEL-----	4
	1S9540	DOWEL-----	2
6	3S5496	SEAL-----	2
7	7M7410	PLUG-----	1

4N2257 CYLINDER BLOCK GROUP - Part 1 of 2

BASIC ENGINE

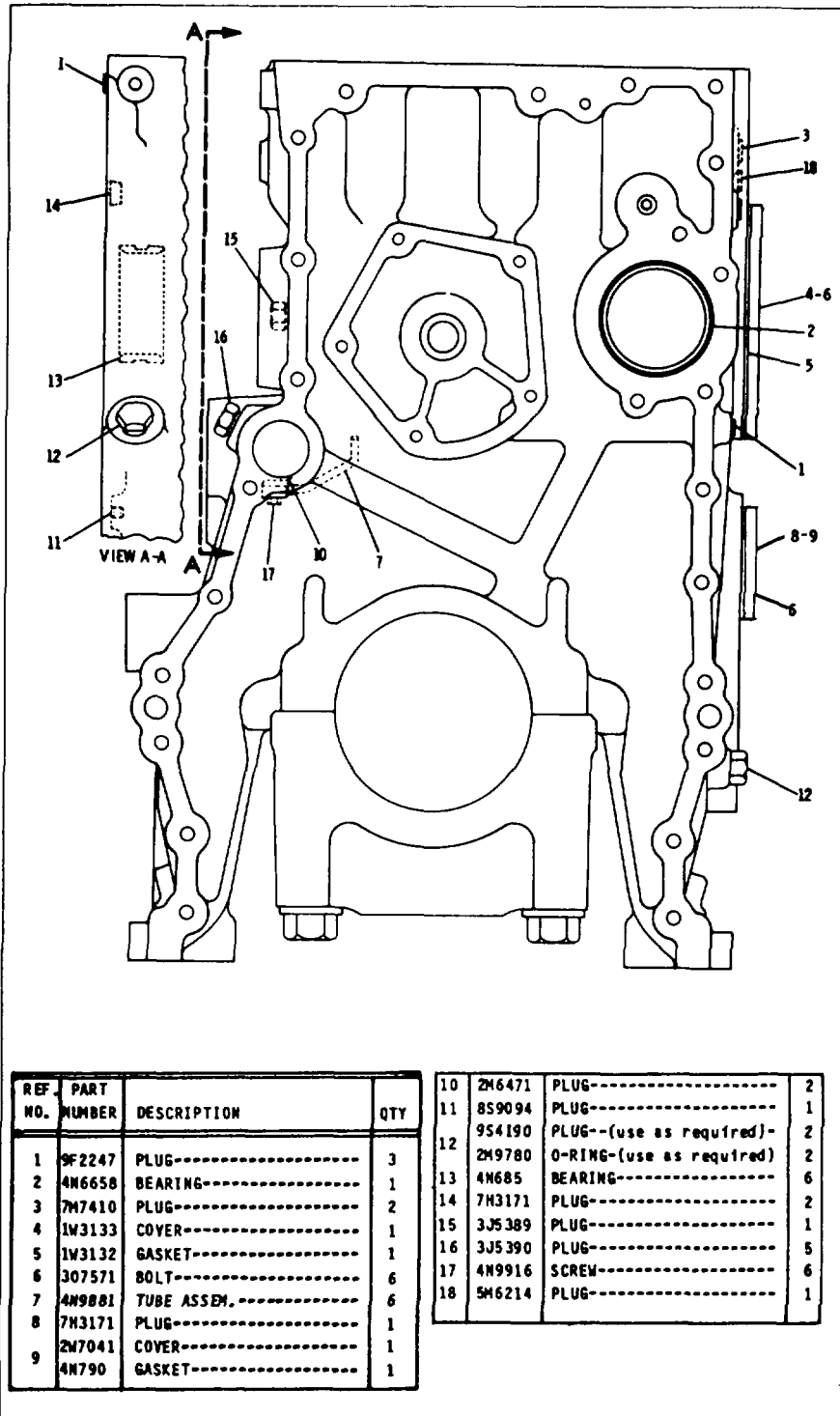

4N2257 CYLINDER BLOCK GROUP - Part 1 of 2

CATERPILLAR 621B TRACTOR

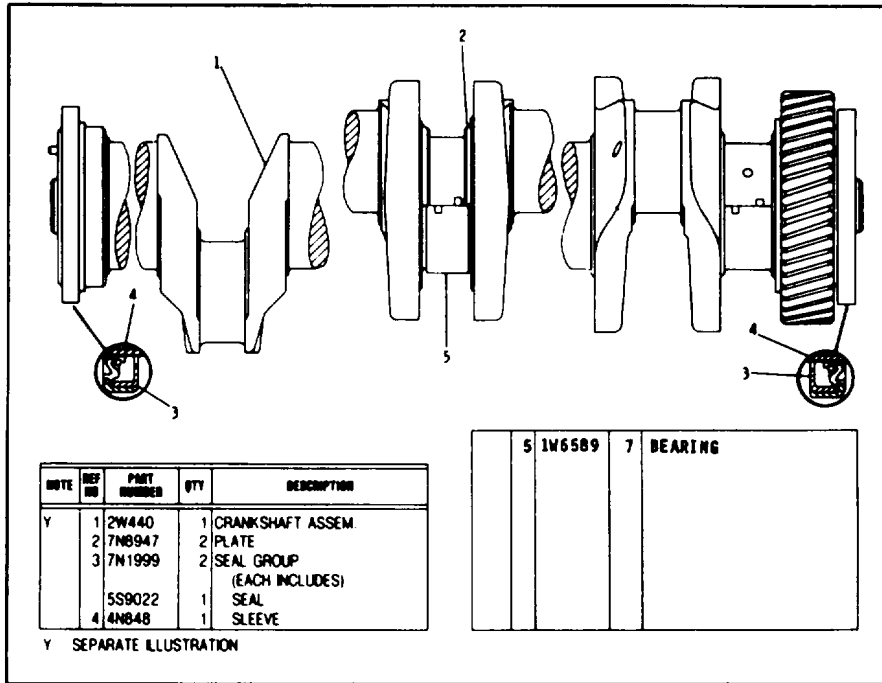

2W1732 CRANKSHAFT GROUP
 2W440 Crankshaft parts are shown on Page 9