

**DIRECT SUPPORT MAINTENANCE  
REPAIR PARTS AND SPECIAL TOOLS LIST  
FOR  
RADIO SETS**

<b>AN/PRC-119</b>	<b>(NSN 5820-01-151-9915)(EIC: L2A)</b>
<b>AN/PRC-119A</b>	<b>(NSN 5820-01-267-9482)(EIC: L2Q)</b>
<b>AN/PRC-119D</b>	<b>(NSN 5820-01-421-0801)(EIC: GC9)</b>
<b>AN/VRC-87</b>	<b>(NSN 5820-01-151-9916)(EIC: L2T)</b>
<b>AN/VRC-87A</b>	<b>(NSN 5820-01-267-9480)(EIC: L22)</b>
<b>AN/VRC-87D</b>	<b>(NSN 5820-01-351-5259)(EIC: GAR)</b>
<b>AN/VRC-88</b>	<b>(NSN 5820-01-151-9917)(EIC: L2U)</b>
<b>AN/VRC-88A</b>	<b>(NSN 5820-01-267-9481)(EIC: L23)</b>
<b>AN/VRC-88D</b>	<b>(NSN 5820-01-352-1694)(EIC: GAS)</b>
<b>AN/VRC-89</b>	<b>(NSN 5820-01-151-9918)(EIC: L2V)</b>
<b>AN/VRC-89A</b>	<b>(NSN 5820-01-267-9479)(EIC: L24)</b>
<b>AN/VRC-89D</b>	<b>(NSN 5820-01-420-6619)(EIC: GD8)</b>
<b>AN/VRC-90</b>	<b>(NSN 5820-01-151-9919)(EIC: L2W)</b>
<b>AN/VRC-90A</b>	<b>(NSN 5820-01-268-5105)(EIC: L25)</b>
<b>AN/VRC-90D</b>	<b>(NSN 5820-01-420-6618)(EIC: GD9)</b>
<b>AN/VRC-91</b>	<b>(NSN 5820-01-151-9920)(EIC: L2X)</b>
<b>AN/VRC-91A</b>	<b>(NSN 5820-01-267-9478)(EIC: L26)</b>
<b>AN/VRC-91D</b>	<b>(NSN 5820-01-420-6621)(EIC: GDG)</b>
<b>AN/VRC-92</b>	<b>(NSN 5820-01-151-9921)(EIC: L2Y)</b>
<b>AN/VRC-92A</b>	<b>(NSN 5820-01-267-9477)(EIC: L27)</b>

**AND**

<b>AN/VRC-92D</b>	<b>(NSN 5820-01-421-2605)(EIC: GDH)</b>
-------------------	---

---

**APPROVED FOR PUBLIC RELEASE; DISTRIBUTION IS UNLIMITED**

---

**HEADQUARTERS, DEPARTMENT OF THE ARMY  
30 NOVEMBER 2002**

Technical Manual

No. 11-5820-890-30P-1

HEADQUARTERS,  
Department of the Army  
Washington, D.C., 30 November 2002

**DIRECT SUPPORT MAINTENANCE  
REPAIR PARTS AND SPECIAL TOOLS LIST  
FOR  
RADIO SETS**

<b>AN/PRC-119</b>	<b>(NSN 5820-01-151-9915) (EIC: L2A)</b>
<b>AN/PRC-119A</b>	<b>(NSN 5820-01-267-9482) (EIC: L2Q)</b>
<b>AN/PRC-119D</b>	<b>(NSN 5820-01-421-0801) (EIC: GC9)</b>
<b>AN/VRC-87</b>	<b>(NSN 5820-01-151-9916) (EIC: L2T)</b>
<b>AN/VRC-87A</b>	<b>(NSN 5820-01-267-9480) (EIC: L22)</b>
<b>AN/VRC-87D</b>	<b>(NSN 5820-01-351-5259) (EIC: GAR)</b>
<b>AN/VRC-88</b>	<b>(NSN 5820-01-151-9917) (EIC: L2U)</b>
<b>AN/VRC-88A</b>	<b>(NSN 5820-01-267-9481) (EIC: L23)</b>
<b>AN/VRC-88D</b>	<b>(NSN 5820-01-352-1694) (EIC: GAS)</b>
<b>AN/VRC-89</b>	<b>(NSN 5820-01-151-9918) (EIC: L2V)</b>
<b>AN/VRC-89A</b>	<b>(NSN 5820-01-267-9479) (EIC: L24)</b>
<b>AN/VRC-89D</b>	<b>(NSN 5820-01-420-6619) (EIC: GD8)</b>
<b>AN/VRC-90</b>	<b>(NSN 5820-01-151-9919) (EIC: L2W)</b>
<b>AN/VRC-90A</b>	<b>(NSN 5820-01-268-5105) (EIC: L25)</b>
<b>AN/VRC-90D</b>	<b>(NSN 5820-01-420-6618) (EIC: GD9)</b>
<b>AN/VRC-91</b>	<b>(NSN 5820-01-151-9920) (EIC: L2X)</b>
<b>AN/VRC-91A</b>	<b>(NSN 5820-01-267-9478) (EIC: L26)</b>
<b>AN/VRC-91D</b>	<b>(NSN 5820-01-420-6621) (EIC: GDG)</b>
<b>AN/VRC-92</b>	<b>(NSN 5820-01-151-9921) (EIC: L2Y)</b>
<b>AN/VRC-92A</b>	<b>(NSN 5820-01-267-9477) (EIC: L27)</b>
	<b>AND</b>
<b>AN/VRC-92D</b>	<b>(NSN 5820-01-421-2605) (EIC: GDH)</b>

Current as of 1 August 2002

**REPORTING ERRORS AND RECOMMENDING IMPROVEMENTS**

You can help improve this manual. If you find any mistakes, or if you know of a way to improve the procedures, please let us know. Mail your letter, DA Form 2028 (Recommended Changes to Publications and Blank Forms) or DA Form 2028-2 located in back of this manual direct to: Commander, US Army Communications-Electronics Command and Fort Monmouth, ATTN: AMSEL-LC-LEO-D-CS-CFO, Fort Monmouth, New Jersey 07703-5006. The fax number is 732-532-1413, DSN 992-1413. You may also e-mail your recommendations to [AMSEL-LC-LEO-PUBS-CHG@cecom3.monmouth.army.mil](mailto:AMSEL-LC-LEO-PUBS-CHG@cecom3.monmouth.army.mil)

A reply will be furnished direct to you.

\*This manual supersedes TM 11-5820-890-30P-1, dated 1 October 1997

TABLE OF CONTENTS

	Page	Illus/ Figure
Section I. Introduction .....	1	
Section II. Repair Parts List .....	1	
Group 00 SINCGARS Family of Radios.....	1-1	1
57 Radio Set AN/PRC-119D .... (see Figure 1 sheet 1 for listing of parts)		
01 Radio Set AN/PRC-119A .... (see Figure 1 sheet 2 for listing of parts)		
02 Radio Set AN/PRC-119..... (see Figure 1 sheet 3 for listing of parts)		
58 Radio Set AN/VRC/87D ..... (see Figure 1 sheet 4 for listing of parts)		
03 Radio Set AN/VRC/87A ..... (see Figure 1 sheet 5 for listing of parts)		
05 Radio Set AN/VRC/87..... (see Figure 1 sheet 6 for listing of parts)		
59 Radio Set AN/VRC-88D ..... (see Figure 1 sheet 7 for listing of parts)		
07 Radio Set AN/VRC-88A ..... (see Figure 1 sheet 8 for listing of parts)		
09 Radio Set AN/VRC-88 ..... (see Figure 1 sheet 9 for listing of parts)		
60 Radio Set AN/VRC/89D ..... (see Figure 1 sheet 10 for listing of parts)		
11 Radio Set AN/VRC/89A ..... (see Figure 1 sheet 11 for listing of parts)		
12 Radio Set AN/VRC/89..... (see Figure 1 sheet 12 for listing of parts)		
61 Radio Set AN/VRC-90D ..... (see Figure 1 sheet 13 for listing of parts)		
13 Radio Set AN/VRC-90A ..... (see Figure 1 sheet 14 for listing of parts)		
14 Radio Set AN/VRC-90 ..... (see Figure 1 sheet 15 for listing of parts)		
62 Radio Set AN/VRC-91D ..... (see Figure 1 sheet 16 for listing of parts)		
15 Radio Set AN/VRC-91A ..... (see Figure 1 sheet 17 for listing of parts)		
16 Radio Set AN/VRC-91 ..... (see Figure 1 sheet 18 for listing of parts)		
63 Radio Set AN/VRC-92D ..... (see Figure 1 sheet 19 for listing of parts)		
17 Radio Set AN/VRC-92A ..... (see Figure 1 sheet 20 for listing of parts)		
18 Radio Set AN/VRC-92 ..... (see Figure 1 sheet 21 for listing of parts)		
Ancillary Items ..... (see Figure 1 sheets 22 – 23 for listing of parts)		
Manpack Antenna AS-3683/PRC .....	2-1	2
Handheld Remote Control Radio Device C-12493/U .....	2A-1	2A
Electrical Special Purpose Cable Assembly CX-13293/VRC.....	3-1	3
19 Control-Monitor C-11291/VRC .....	4-1	4
190102 Control-Monitor Panel.....	8-1	8
20 Battery Box CY-8523A/PRC .....	12-1	12
21 Battery Box CY-8523C/PRC .....	12A-1	12A
22 Battery Tray CY-8664/VRC .....	13-1	13
2201 Electronic Components Assembly - Battery Tray.....	14-1	14
220101 Electrical Chassis - Battery Tray .....	15-1	15
23 Electronic Counter-Countermeasures Fill Device MX-18290/VRC .....	16-1	16
24 Electronic Counter-Countermeasures Fill Device MX-10579/VRC .....	17-1	17
25 Power Supply Adapter MX-10862/VRC .....	18-1	18
2501 Electrical Equipment Chassis - Power Supply Adapter .....	19-1	19
250101 Electrical Equipment Chassis Assembly.....	20-1	20
26 Radio Receiver-Transmitter RT-1523(C)/U.....	24-1	24
2616 Receiver-Transmitter Subassembly.....	51-1	51
261601 Receiver-Transmitter Panel Assembly .....	52-1	52
26160202 Electrical Equipment Chassis.....	56-1	56
27 Radio Receiver-Transmitter RT-1439/VRC.....	57-1	57
2716 Electrical Equipment Chassis - Receiver-Transmitter Subassembly.....	74-1	74
271601 Receiver-Transmitter Panel Assembly .....	75-1	75
27160202 Electrical Equipment Chassis Assembly.....	79-1	79
28 Receiver-Transmitter Control C-11561(C)/U.....	80-1	80
2813 Receiver-Transmitter Control Subassembly.....	84-1	84
281301 Receiver-Transmitter Control Panel Assembly .....	85-1	85

## TABLE OF CONTENTS - continued

	Page	Illus/ Figure
29 Vehicular Amplifier-Adapter AM-7239/VRC .....	86-1	86
2901 Electrical Equipment Chassis - Amplifier-Adapter Assembly .....	87-1	87
290101 Electronic Components Assembly - Power Control .....	88-1	88
29010101 Terminal Board Assembly (see group 290101 for listing of parts)		
29010102 Electronics Case .....	89-1	89
290102 Electronic Components Assembly - One Watt Audio Amplifier .....	90-1	90
29010201 Branched Wiring Harness - One Watt Audio Amplifier W1 .....	91-1	91
29010202 One Watt Audio Amplifier Case .....	92-1	92
290103 Branched Electrical Special Purpose Cable Assembly - W3 .....	93-1	93
290104 Wiring Harness - W2 .....	94-1	94
290105 Electrical Equipment Chassis .....	94A-1	94A
30 Radio Frequency Amplifier AM-7238/VRC .....	98-1	98
31 Long Manpack Antenna AS-4266A/PRC .....	104A-1	104A
33 Vehicular Antenna AS-3900A/VRC .....	107-1	107
3301 Antenna Subassembly .....	108-1	108
34 Vehicular Antenna AS-3916/VRC .....	108A-1	108A
35 Electrical Equipment Mounting Base MT-6352/VRC .....	109-1	109
3501 Electrical Connector Assembly .....	110-1	110
36 Electrical Equipment Mounting Base MT-6576/VRC .....	111-1	111
3601 Electrical Connector Assembly (see group 3501 for listing of parts)		
37 Electronic Equipment Auxiliary Kit MK-2312/VRC .....	112-1	112
3701 Electrical Equipment Mounting Base MT-6353/VRC .....	113-1	113
370101 Chassis/Power Supply Assembly .....	114-1	114
37010102 Electrical Equipment Chassis .....	116-1	116
3701010201 Power Supply Case .....	117-1	117
370102 Electrical Equipment Mounting Base .....	118-1	118
38 Electronic Equipment Auxiliary Kit MK-2499/VRC (see TM 11-5820-957-23P for listing of parts)		
39 Control Unit - Loudspeaker LS-671/VRC .....	119-1	119
40 Maintenance Group OA-9297/GRC		
4001 Interconnecting Device J-4501/GRC .....	120-1	120
400101 Electrical Special Purpose Cable Assembly - Radio Frequency Power Amplifier Adapter .....	121-1	121
400102 Tool and Equipment Kit Chest .....	122-1	122
400104 Test Adapter .....	123-1	123
400106 Electrical Special Purpose Cable Assembly - Control-Monitor .....	124-1	124
400107 Electrical Special Purpose Cable Assembly .....	125-1	125
400108 Static Control Tablerunner .....	126-1	126
400109 Branched Wiring Harness - Receiver - Transmitter .....	127-1	127
400110 Branched Wiring Harness - Amplifier - Adapter .....	128-1	128
400111 Branched Wiring Harness - Control - Monitor .....	129-1	129
400112 Branched Wiring Harness - Radio Frequency Power Amplifier .....	130-1	130
400113 Branched Wiring Harness - Auxiliary RFPA Mount .....	131-1	131
400114 Branched Wiring Harness - Amplifier - Adapter .....	132-1	132
400115 Branched Wiring Harness - Battery Box .....	133-1	133
400116 Electrical Special Purpose Cable Assembly .....	134-1	134
400117 Branched Wiring Harness - Power Supply Adapter .....	135-1	135
400118 Branched Wiring Harness - Battery Tray .....	136-1	136
400119 Branched Wiring Harness - Control Unit Loudspeaker .....	137-1	137
400120 Branched Wiring Harness - SRCU .....	138-1	138

TABLE OF CONTENTS - continued

	Page	Illus/ Figure
4002 Electrical Equipment Mounting Base MT-6352/VRC (see group 35 for listing of parts)		
4003 Radio Receiver-Transmitter RT-1439/VRC (see group 27 for listing of parts)		
4004 Vehicular Amplifier-Adapter AM-7239/VRC (see group 29 for listing of parts) or Vehicular Amplifier-Adapter AM-7239B/VRC (see group 51 for listing of parts) or Vehicular Amplifier-Adapter AM-7239A/VRC (see TM 11-5820-890-30P-2 for listing of parts)		
4005 Electronic Counter-Countermeasures Fill Device MX-10579/VRC (see group 24 for listing of parts)		
49 Maintenance Group OA-9263A/GRC		
4901 Interconnecting Device J-4501/GRC (see group 4001 for listing of parts)		
490101 Electrical Special Purpose Cable Assembly - Radio Frequency Power Amplifier Adapter (see group 400101 for listing of parts)		
490102 Tool and Equipment Kit Chest (see group 400102 for listing of parts)		
490104 Test Adapter (see group 400104 for listing of parts)		
490106 Electrical Special Purpose Cable Assembly - Control Monitor (see group 400106 for listing of parts)		
490107 Electrical Special Purpose Cable Assembly (see group 400107 for listing of parts)		
490108 Static Control Tablerunner (see group 400108 for listing of parts)		
490109 Branched Wiring Harness - Amplifier-Adapter (see group 400109 for listing of parts)		
490110 Branched Wiring Harness - Amplifier-Adapter (see group 400110 for listing of parts)		
490111 Branched Wiring Harness - Control-Monitor (see group 400111 for listing of parts)		
490112 Branched Wiring Harness - Radio Frequency Power Amplifier (see group 400112 for listing of parts)		
490113 Branched Wiring Harness - Auxiliary RFPA Mount (see group 400113 for listing of parts)		
490114 Branched Wiring Harness - Amplifier-Adapter (see group 400114 for listing of parts)		
490115 Branched Wiring Harness - Battery Box (see group 400115 for listing of parts)		
490116 Electrical Special Purpose Cable Assembly (see group 400116 for listing of parts)		
490117 Branched Wiring Harness - Power Supply Adapter (see group 400117 for listing of parts)		
490118 Branched Wiring Harness - Battery Tray (see group 400118 for listing of parts)		
490119 Branched Wiring Harness - Control Unit Loudspeaker (see group 400119 for listing of parts)		
490120 Branched Wiring Harness - SRCU (see group 400120 for listing of parts)		
4902 Electrical Equipment Mounting Base MT-6352/VRC (see group 35 for listing of parts)		
4903 Radio Receiver-Transmitter RT-1439/VRC (see group 27 for listing of parts)		

TABLE OF CONTENTS - continued

	Page	Illus/ Figure
4904 Vehicular Amplifier-Adapter AM-7239/VRC (see group 29 for listing of parts) or Vehicular Amplifier-Adapter AM-7239B/VRC (see group 51 for listing of parts) or Vehicular Amplifier-Adapter AM-7239A/VRC (see TM 11-5820-890-30P-2 for listing of parts)		
4905 Electronic Counter-Countermeasures Fill Device MX-10579/VRC (see group 24 for listing of parts)		
51 Vehicular Amplifier-Adapter AM-7239B/VRC.....	144-1	144
5103 Electrical Equipment Chassis - Amplifier-Adapter .....	146-1	146
510301 Electrical Chassis - Electronic Component - Adapter /Power Supply .....	147-1	147
51030101 Electrical Heatsink - Electronic Component - Power Supply .....	148-1	148
51030102 Electrical Cover - Electronic Component - Power Supply.....	149-1	149
51030103 Branched Electrical Special Purpose Cable Assembly .....	150-1	150
510302 Electronic Components Assembly - One Watt Audio Amplifier.....	151-1	151
51030201 Branched Wiring Harness - One Watt Audio Amplifier.....	151A-1	151A
51030202 Electronic Communications Equipment Case - One Watt Audio Amplifier.....	152-1	152
510303 Electrical Components Assembly - Power Control.....	153-1	153
51030301 Power Control Case.....	154-1	154
52 Radio Receiver-Transmitter RT-1523B(C)/U .....	155-1	155
5212 Receiver-Transmitter Subassembly.....	166A-1	166A
521201 Receiver-Transmitter Panel Assembly .....	166B-1	166B
521202 Electrical Equipment Chassis Assembly .....	166C-1	166C
52120202 Electrical Equipment Chassis (see group 26160202 for listing of parts)		
54 Radio Frequency Amplifier AM-7238B/VRC .....	166D-1	166D
55 Radio Receiver-Transmitter RT-1523C(C)/U .....	166E-1	166E
5506 Receiver-Transmitter Subassembly.....	166Q-1	166Q
550601 Receiver-Transmitter Panel Assembly .....	166R-1	166R
550602 Electrical Equipment Chassis.....	166S-1	166S
56 Vehicular Amplifier-Adapter AM-7239C/VRC.....	166T-1	166T
5601 Power Supply - Vehicular Adapter.....	166U-1	166U
560101 Branched Cable Assembly - Major Harness .....	166V-1	166V
5602 Electronic Components Assembly - Sidehat .....	166W-1	166W
560204 GPS Assembly - Splitter .....	166X-1	166X
56020401 Stub Cable Assembly .....	166Y-1	166Y
560205 INC Harness Assembly.....	166Z-1	166Z
57 Radio Set AN/PRC-119D (see group 00 for listing of parts)		
58 Radio Set AN/VRC-87D (see group 00 for listing of parts)		
59 Radio Set AN/VRC-88D (see group 00 for listing of parts)		
60 Radio Set AN/VRC-89D (see group 00 for listing of parts)		
61 Radio Set AN/VRC-90D (see group 00 for listing of parts)		
62 Radio Set AN/VRC-91D (see group 00 for listing of parts)		
63 Radio Set AN/VRC-92D (see group 00 for listing of parts)		
95 Interconnecting Group ON-373/GRC.....	167-1	167
9501 Electrical Communications Equipment Case .....	168-1	168
950101 Equipment Case .....	169-1	169
950102 Equipment Cover.....	170-1	170

TABLE OF CONTENTS - continued

	Page	Illus/ Figure
9502 Power Supply .....	171-1	171
950201 Chassis/Power Supply Assembly (see group 370101 for listing of parts)		
95020102 Electrical Equipment Chassis (see group 37010102 for listing of parts)		
9503 Electrical Wiring Harness - Radio Frequency Power Amplifier Adapter .....	171A-1	171A
9504 Electrical Wiring Harness - Fill Device .....	171B-1	171B
9505 Branched Wiring Harness - Receiver-Transmitter .....	171C-1	171C
9506 Branched Wiring Harness - Control-Monitor .....	171D-1	171D
9507 Branched Wiring Harness - Electrical Power .....	171E-1	171E
9510 Static Control Tablerunner (see group 400108 for listing of parts)		
9511 Branched Wiring Harness - Amplifier-Adapter .....	171F-1	171F
9512 Electrical Wiring Harness - Power Supply .....	171G-1	171G
9513 Branched Wiring Harness - Auxiliary RFPA Mount .....	171H-1	171H
9514 Branched Wiring Harness - Power Supply Adapter .....	171J-1	171J
9515 Branched Wiring Harness - Battery Box .....	171K-1	171K
9516 Branched Wiring Harness - Battery Tray .....	171L-1	171L
9517 Branched Wiring Harness - Control Unit Loudspeaker .....	171M-1	171M
9518 Branched Wiring Harness - Remote Control Unit .....	171N-1	171N
9519 Branched Wiring Harness - Splitter Cable .....	171P-1	171P
9520 Test Adapter .....	171Q-1	171Q
952001 Electronic Components Assembly - Test Adapter .....	171R-1	171R
96 Interconnecting Group ON-373A/GRC (see group 95 for listing of parts)		
9601 Electrical Communications Equipment Case (see group 9501 for listing of parts)		
960101 Equipment Case (see group 950101 for listing of parts)		
960102 Equipment Cover (see group 950102 for listing of parts)		
9602 Power Supply (see group 9502 for listing of parts)		
960201 Chassis/Power Supply Assembly (see group 370101 for listing of parts)		
96020102 Electrical Equipment Chassis (see group 37010102 for listing of parts)		
9603 Electrical Wiring Harness - Radio Frequency Power Amplifier Adapter (see group 9503 for listing of parts)		
9604 Electrical Wiring Harness - Fill Device (see group 9504 for listing of parts)		
9605 Branched Wiring Harness - Receiver - Transmitter (see group 9505 for listing of parts)		
9606 Branched Wiring Harness - Control Monitor (see group 9506 for listing of parts)		
9607 Branched Wiring Harness - Electrical Power (see group 9507 for listing of parts)		
9610 Static Control Tablerunner (see group 400108 for listing of parts)		
9611 Branched Wiring Harness - Amplifier - Adapter (see group 9511 for listing of parts)		
9612 Electrical Wiring Harness - Power Supply (see group 9512 for listing of parts)		
9613 Branched Wiring Harness - Auxiliary RFPA Mount (see group 9513 for listing of parts)		
9614 Branched Wiring Harness - Power Supply Adapter (see group 9514 for listing of parts)		

TABLE OF CONTENTS - continued

		Page	Illus/ Figure
	9615 Branched Wiring Harness - Battery Box (see group 9515 for listing of parts)		
	9616 Branched Wiring Harness - Battery Tray (see group 9516 for listing of parts)		
	9617 Branched Wiring Harness - Control Unit Loudspeaker (see group 9517 for listing of parts)		
	9618 Branched Wiring Harness - Remote Control Unit (see group 9518 for listing of parts)		
	9619 Branched Wiring Harness - Splitter Cable (see group 9519 for listing of parts)		
	9624 Branched Wiring Harness - Amplifier-Adapter .....	171T-1	171T
	9625 Branched Wiring Harness - Receiver-Transmitter.....	171U-1	171U
Section	III. SPECIAL TOOLS LIST		
	SINCGARS Maintenance Group Sets .....	172-1	172
	Maintenance Group OA-9297/GRC.....	173-1	173
	Interconnecting Device J-4501/GRC .....	174-1	174
	Electronic Equipment Tool Kit .....	175-1	175
	Electronic Equipment Parts Kit.....	176-1	176
	Maintenance Group OA-9263A/GRC .....	182-1	182
	Interconnecting Group ON-373/GRC.....	183-1	183
	Electronic Equipment Parts Kit.....	184-1	184
	Electronic Equipment Tool Kit .....	185-1	185
	Interconnecting Group ON-373A/GRC .....	186-1	186
	Electronic Equipment Parts Kit (see Figure 184 for listing of parts)		
	Electronic Equipment Tool Kit (see Figure 185 for listing of parts)		
Section	IV. Cross-Reference Indexes		
	National Stock Number Index .....	I-1	
	Part Number Index .....	I-41	



# SECTION I INTRODUCTION

---

## 1. Scope

This RPSTL lists and authorizes spares and repair parts; special tools; special test, measurement, and diagnostic equipment (TMDE); and other special support equipment required for performance of unit and direct support maintenance of AN/PRC-119/A/D, AN/VRC-87/A/D, AN/VRC-88/A/D, AN/VRC-89/A/D, AN/VRC-90/A/D, AN/VRC-91/A/D, and AN/VRC-92/A/D. It authorizes the requisitioning, issue, and disposition of spares, repair parts and special tools as indicated by the source, maintenance and recoverability (SMR) codes.

## 2. General

This Repair Parts and Special Tools List is divided into the following sections:

*a. Section II, Repair Parts List.* A list of spares and repair parts authorized by this RPSTL for use in the performance of maintenance. The list also includes parts which must be removed for replacement of the authorized parts. Parts lists are composed of functional groups in ascending numeric sequence, with the parts in each group listed in ascending item number sequence. Figure numbers are listed directly beneath the group header. Repair part kits are listed separately in their own functional group within section II. Repair parts for reparable special tools are also listed in this section. Items are shown on the associated illustration.

*b. Section III, Special Tools List.* A list of special tools, special TMDE, and other special support equipment authorized by this RPSTL (as indicated by Basis of Issue (BOI) information in DESCRIPTION AND USABLE ON CODE (UOC) column (5) for the performance of maintenance.

*c. Section IV. Cross-Reference Indexes.* There are two cross-reference indexes in this RPSTL: the National Stock Number Index and the Part Number Index. The National Stock Number Index refers you to the figure and item number. The Part Number Index refers you to the figure and item number.

## 3. Explanation of Columns (Sections II and III)

*a. Item No. (Column (1)).* Indicates the number used to identify items called out in the illustration.

*b. SMR CODE (Column (2)).* The source, maintenance, and recoverability (SMR) code is a five-position code containing supply/requisitioning information, maintenance category authorization criteria, and disposition instruction as shown in the following breakout:

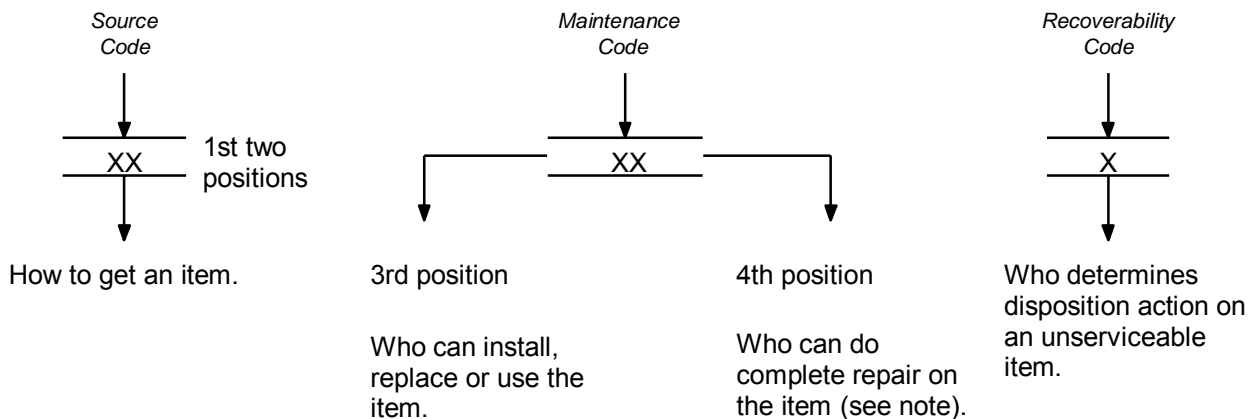

### NOTE

Complete repair: Maintenance capacity, capability, and authority to perform all corrective maintenance tasks of the "Repair" function in a use/user environment in order to restore serviceability to a failed item.

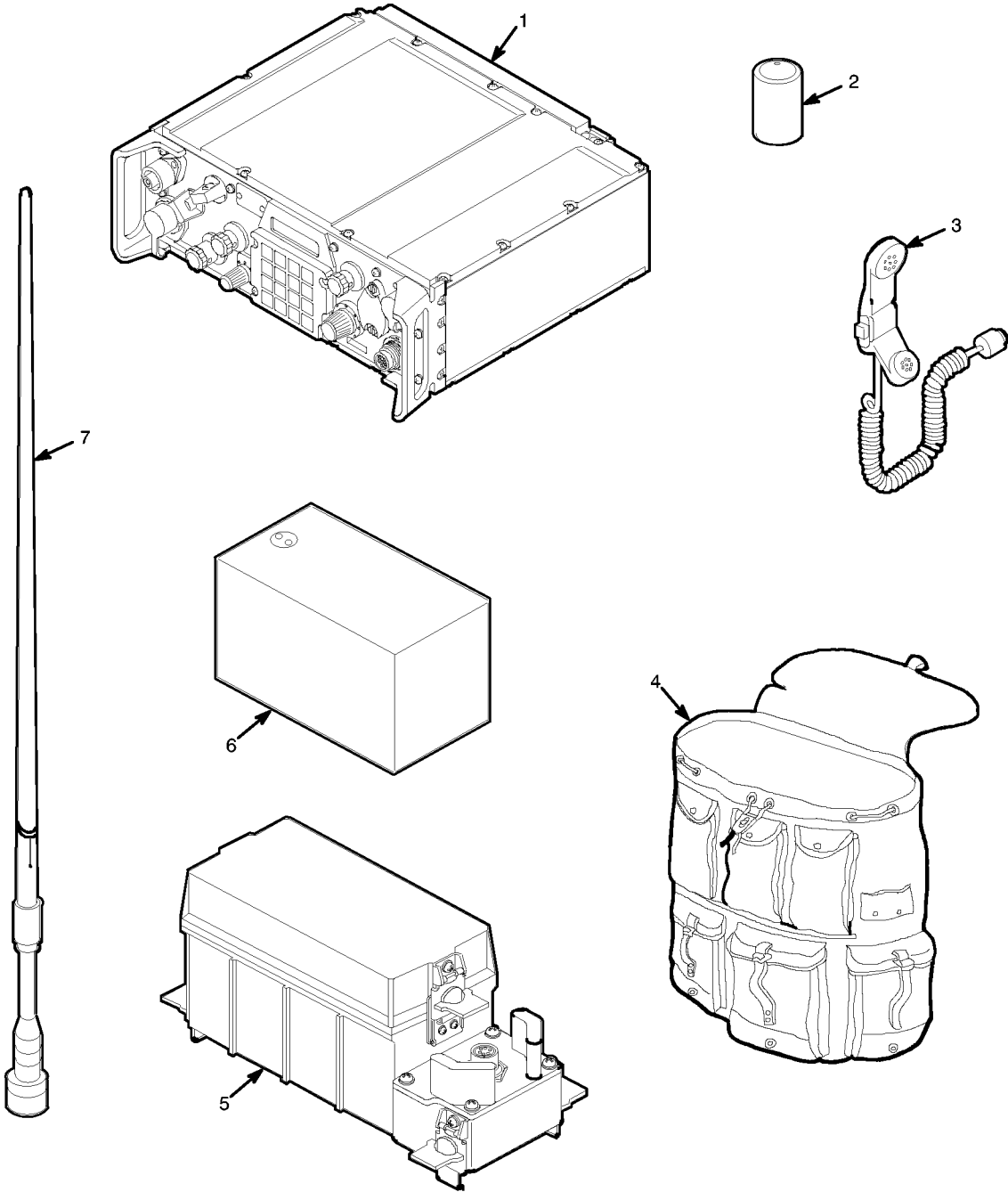

EL9WK001

Figure 1. SINGARS Family of Radios (AN/PRC-119D) (Sheet 1 of 23)